



Client Information

Company name _____

Contact name _____

Street address _____

Postal/Zip code, city _____

Country _____

Phone _____

Email _____

Project Information

Project name _____

Street address _____

Postal/Zip code, city _____

Country _____

Hight above sea level (m) _____

Tilt angle _____

Total project size (kWp) _____

Distance front edge module to ground (m) _____
(min. 0.6 / for sheep grazing min. 1m)

Module

Module orientation Portrait Landscape

Modules per row _____ Number of rows _____

Module manufacturer/model _____

Module dimensions _____

Modules per string _____

Module framed yes no

Module power _____ Wp



Terrain

Total are in m² _____

OR total area in ha _____

Terrain topography _____

If available, please also send layout with topography.

Slope of terrain (°)

_____ _____ _____
North South East-West

If no information on slope is given, flat terrain is assumed.

Special terrain

- Landfill
- Conversion area
- Flood plain
- Marsh
- Rice field
- Sand pit

Terrain Category

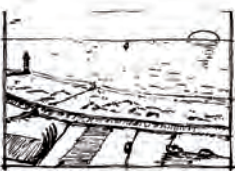

Category I
Inland waters, coastal areas exposed to the open ocean (not in Germany and Austria)



Category II
Plane, flat land without obstructions.

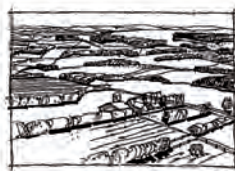

Category II/III
Terrain with hedges, individual farmsteads, houses or trees, e.g. agricultural areas.



Category III
Suburbs, industrial or commercial areas, forests.

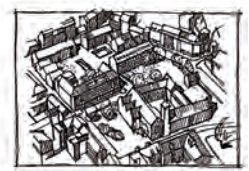

Category IV
Urban areas (15% of the area is covered in buildings with a median height of more than 15 m)

Please note:

For accurate design and determination of the embedment depth of (helical) piles, the project site requires a geotechnical survey. Should you be interested in this service, please fill out and sign below form. Final pricing can only be provided based on a geotechnical report issued by SL Rack specialists.

Geological Survey/Load Testing

State of Project Site

- It is currently being used for agriculture and has yet to be harvested.
- It has already been harvested and is in a fallow state.
- It is fenced in and gate has to be unlocked for access.
- There are still bushes and/or trees at site.
- The soil is currently softened by rain- or groundwater
- Walls/foundations are on site
- Site consists partially or completely of refill.
Which type of refill? Gravel? Is the site recultivated?

Current Earthworks

- Earthworks had taken place at site.
- Currently earthworks are taking place at site.
- Earthworks are planned for the site.

Explosive ordnance

Site is:

- Free of explosive ordnance
- Contaminated by explosive ordnance

Contact at Site

Land owner or tenant have to be notified by you well in advance about the planned load tests. If necessary, wait until the field has been harvested. In case of a fenced-in area, access has to be arranged.

Contact person

Phone

Street address

Postal/Zip code, city

Additional information on ground conditions

Additional information on site conditions

Supply Lines

Are there supply lines on site? Please mark and supply plans with dimensions if applicable:

- Electricity
- Water
- Gas
- Telephone
- Drainage
- There are no supply-lines
- Other:

We require the following documents at least 2 weeks before work commences:

- Modul layout plan to recognise site boundaries, module tilt and orientation of the tables (east-west or south)
- Site plan (topographical plan or cadastral plan, also from internet map material)
- Supply line plans (gas/water/power/telephone, etc.)
- Corner coordinates of the site, e.g. as KMZ-file for display in Google Earth, or the following information for Google Maps:

Geographic (degrees° min.'sec."")

or UTM



In order to carry out load testing, the following must be observed:

- Testing can only take place, once we received the completed and signed check list as well as all the requested documents.
- 2-3 days before testing we need to be informed whether the soil is soaked by rain- or groundwater.
- Before the beginning of the geological testing, your employee must instruct our geotechnical engineer on site about the property to be tested using a site plan. This way, testing on third-party land or damage to supply lines can be avoided.
- The site should be accessible by a SUV with trailer. Please send us photos or videos of the site, clearly showing that we can walk and drive on it.
- A probe crawler must be able to move across the site. Please be advised that the probe crawler is only capable of driving across a slope with an inclination of up to 15°. Any steeper slopes will result in the vehicle tipping over. Additionally, the range of movement of the mast, which must be in a vertical position during testing, will no longer be guaranteed on an incline of more than 15°.
- If a geological survey of the area to be investigated has already been carried out, or if there are any special features regarding the ground, we need to be informed in advance.
- The site is evaluated and the embedment depth of the (helical) piles is determined based on the test results. Therefore, the test results have validity based on the conditions of the site at the time of testing.
- Changes made to the site after testing (e.g. earthworks, backfilling, re-grading, etc.) may require new testing, which may result in additional costs to be borne by the client.

Supply Lines

Supply lines, as well as their operators, are listed in the land register extract under easements. The client has to inform SL Rack of the location of the underground supply lines. As part of a briefing, the test locations have to be approved by the client. SL Rack GmbH expressly excludes any liability for damage, particularly consequential damage of any kind, to underground supply lines and any other installations (even if test pits have been created).

Explosive ordnance and explosive remnants of war

It is necessary to check for the presence of explosive ordnance as well as bomb craters when planning the project and before carrying out geological testing. For industrial sites and old airports in particular, we recommend checking the aerial image database (www.luftbilddatenbank.de).

I hereby confirm that the site plans and the information on the check list are correct and current. I am aware that changes to the site after testing may require new testing to be carried out, the cost of which will be borne by the client.

Place

Date

Signature

Subject to technical
changes and misprints.
Version 06/2024 V5