



Trapez 3

Item no. 11205-03

Trapez 3-60

Item no. 11205-04

Your advantages with our products

- » Installation on top of the rib ensures best accessibility and greatest possible distance from the water-bearing layer.
- » Pre-installed EPDM rubber is UV resistant and ensures water-sealing of the attachment.
- » 370 mm long rail can span over several ribs.
- » Convenient and time-saving installation from the top.
- » Use Cross Connector to install additional RAILS.

*Our warranty conditions apply. They are available at www.sl-rack.de



Tools

- » Cordless screwdriver with hex attachment
- » Torque wrench with hex attachment
- » Measuring tools



Documents

- » Product Sheet Trapez 3
 - » Product Sheet Roof
 - » Maintenance instructions for pitched roofs
- All documents are available at www.sl-rack.de

Accessories:



Cross Connector
Item no. 91204-00







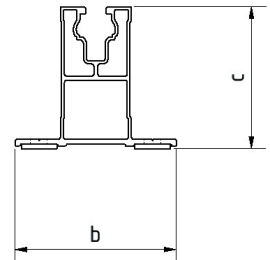
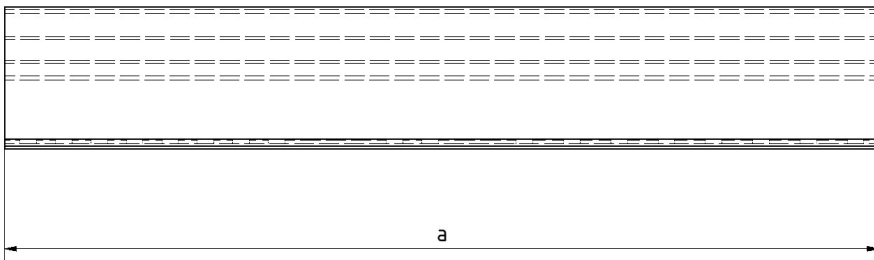
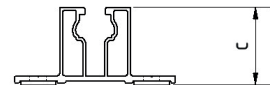



Potential Equalization Plate
Item no. 93201-00

Dimensions:



	a	b	c
Trapez 3	370 mm	68 mm	33 mm
Trapez 3-60	370 mm	68 mm	60 mm

Symbols and special emphasis

	Risk of injury from falling objects. Before starting installation, block off the danger zone and warn people in the vicinity!
	Design, installation and commissioning shall only be carried out by qualified personnel.
	Improper installation can result in damage to the roof and the entire PV system.
	Warning of fall hazard! There is a risk of falling when working on the roof as well as when climbing on and off the roof. Always follow accident prevention regulations and use appropriate fall protection. PV racking systems are not intended to be used as climbing aids or fall protection. The roof must be sturdy enough to stand on.
	Follow these instructions for proper and safe use. Keep for future reference.
	Use a safety harness.
	Wear safety goggles.
	Wear safety gloves.

Installation



⚠ Please note: According to DIN EN 1990-4:2018 paragraph 5.5.1. a minimum sheet metal thickness of 0.75 mm is required for the load-bearing layer, unless the trapezoidal sheet metal manufacturer obtained a General Approval from the Building Authority that allows lower sheet thicknesses. Please verify!

The installation steps are identical for Trapez 3 and Trapez 3-60.

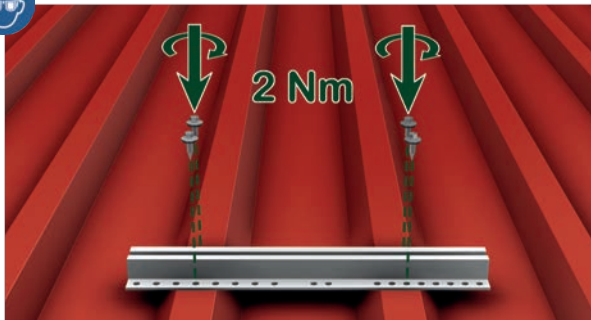

1. Mount Trapez 3 in the appropriate position with as much overlap as possible. Make sure the overlap is identical on both sides.

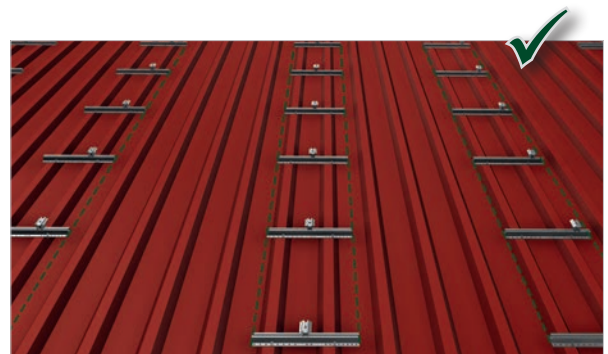
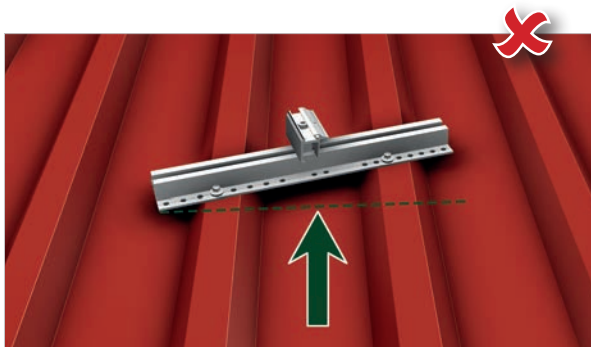

2. Attach Trapez 3 perpendicular to the ribs.

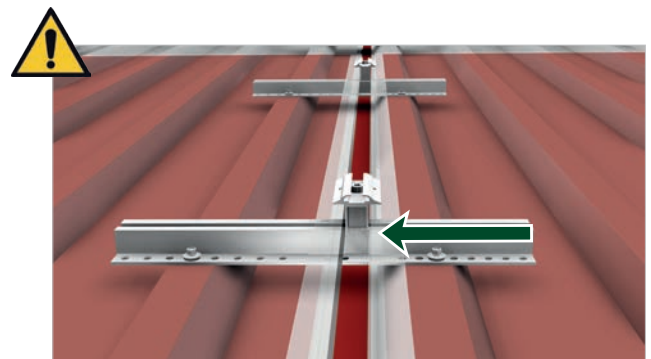
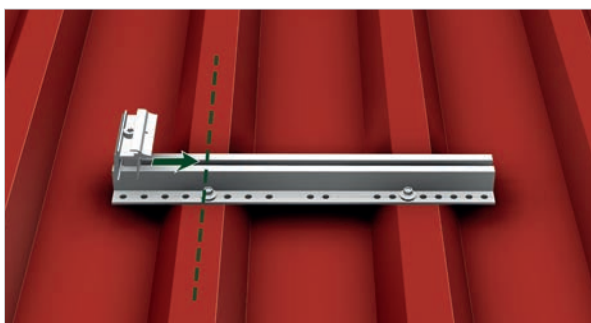

3. Module clamp or Cross Connector must not be mounted in the edge area. Ensure that they are pushed away from the edge at least up to the rib.



Unless otherwise specified by the manufacturer of the trapezoidal or sandwich roof, a thermal break must be provided every 15 m.

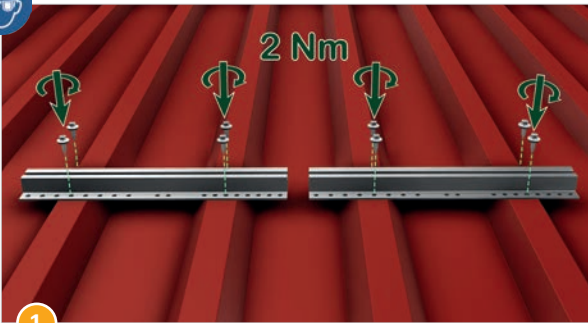

1

Install two Trapez 3 as illustrated.

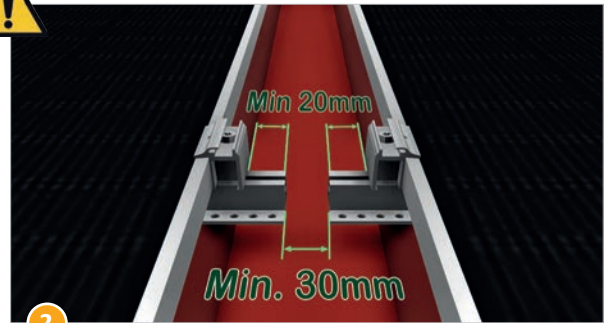

2

Fasten the modules with two opposing end clamps.
Observe the distances!

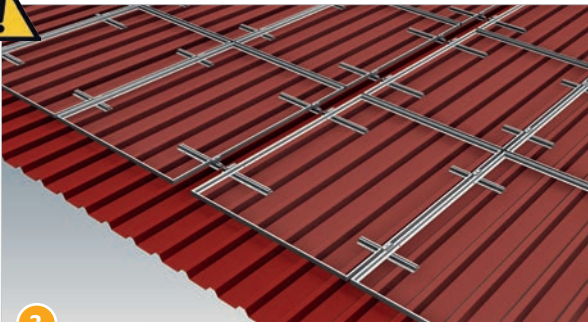

3

This is what the correct installation looks like.



Additional Information

- Disassemble in reverse order, observing all applicable safety regulations.
- For disposal and recycling information, visit www.sl-rack.de.
- For maintenance instructions visit www.sl-rack.de.

Technical Data

Material	Aluminium
Design Tool	SL-Rack-Configurator Solar.Pro.Tool .
Statics	The statics calculation takes place as per the current country-specific standards (EN 1991, EC1 for Germany). Depending on snow or wind loads or for large modules, it may be necessary to use more than the standard four attachment points. Please make sure to comply with the instructions of the module manufacturer contained in the installation manual. We do not assess the load-bearing capacity of the roof.



It is our top priority to make the installation process for you as quick, easy and efficient as possible. Please share your experiences, ideas or criticism with us, so we can continue to improve our products and develop new ones.



SL Rack **Feedback**
[Provide feedback >](#)



SL Rack **Website**
[Check it out >](#)



SL Rack **YouTube**
[Watch videos >](#)

Visit us on



Subject to technical changes
and misprints.
Version 04/2025 V1