



Item no. 82900-1400

Advantages

- » Connects two piles
- » Enables individual extension of piles above grade
- » Compatible with any size pile profile
- » Bypass height limitations imposed by a pile driver
- » Material: high-quality galvanized flat steel (ZM430MAC)

*Our warranty conditions apply.
They are available at www.sl-rack.de



Dimensions

	a	b	c
Pile Connector	159 mm	32 mm	1400 mm

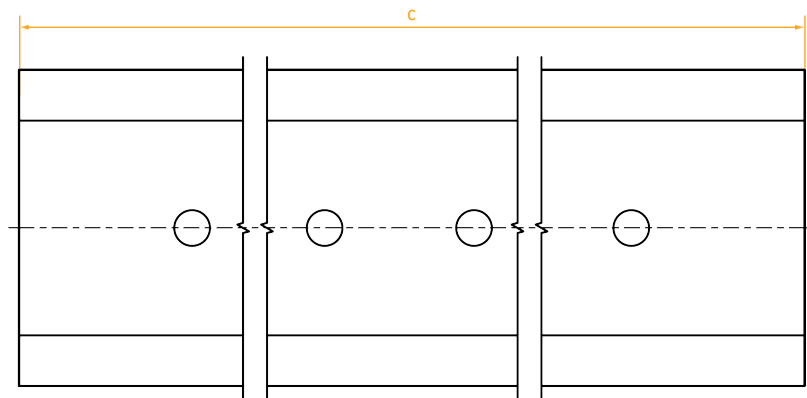

Installation

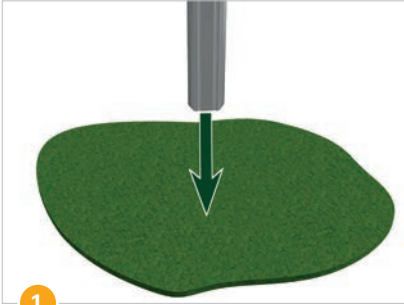

1

Install W-pile with a standard hydraulic pile driver in accordance with the respective ramming plan.



2

Place the pile connector on the **outside** of the pile.



3

Insert 2 bolts through the matching holes in the pile connector and pile. Use a washer under the bolt head and secure the bolt with the nut. *(Bolt head is on the outside.)*

M16 x 30
M16 washer DIN 9021
M16 flange nut with locking teeth



4

Fasten W-steel pile with a tightening torque of 150 Nm.

150 Nm

150 Nm



5

Place second W-pile on pile connector.



6

Insert 2 bolts through the matching holes in the pile connector and the top pile. Use a washer under the bolt head and secure the bolt with the nut. *(Bolt head is on the outside.)*

M16 x 30
M16 washer DIN 9021
M16 Flange nut with locking teeth

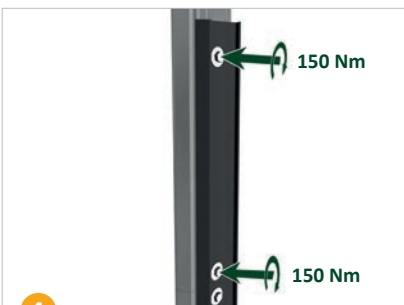

4

Fasten the top W-steel pile with a tightening torque of 150 Nm.

150 Nm

150 Nm



5

Done!



Technical Data

Material High-quality galvanized flat steel (ZM430MAC)



We want to make your everyday work easier.
Your praise, criticism and suggestions for improvement help us to do this.
We look forward to your feedback.



SL Rack **Feedback**
[Write feedback »](#)



SL Rack **Website**
[Learn more »](#)



SL Rack **YouTube**
[Watch videos »](#)

Visit us at



Subject to technical changes
and printing errors.
Version 08/2024 V1